

NOTES

- All dimensions and levels are to be checked on site.
- Any discrepancies are to be reported to the architect before any work commences.
- This drawing shall not be scaled to ascertain any dimensions. Work to figured dimensions only.
- This drawing shall not be reproduced without express written permission from AEW.
- Title overlay drawings and ownership boundaries are produced using all reasonable endeavors. AEW cannot be responsible for the accuracy or scale discrepancy of base plans supplied to them.
- All works are to be undertaken in accordance with Building Regulations and the latest British Standards.
- All proprietary materials and products are to be used strictly in accordance with the manufacturers' recommendations.

CDM 2015

Client notified of duties:
Principal Designer:
Unless noted below, all known hazards have been highlighted on the drawing:

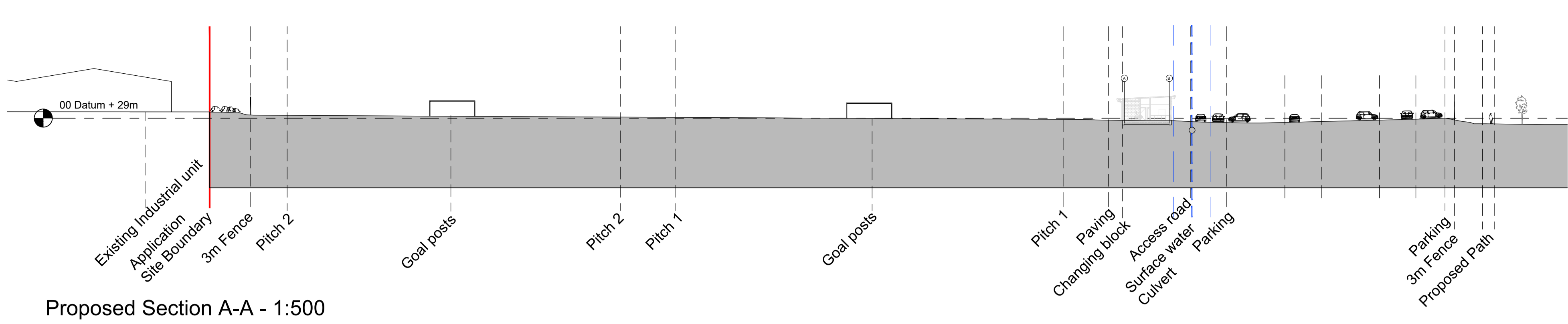

Proposed Section A-A - 1:500

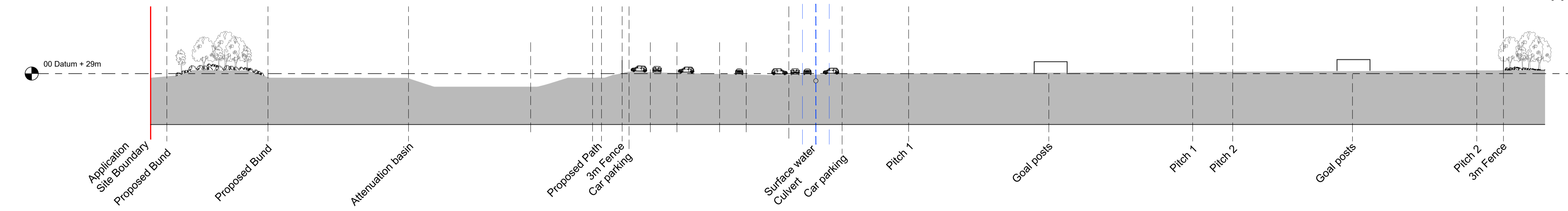

Proposed Section B-B - 1:500

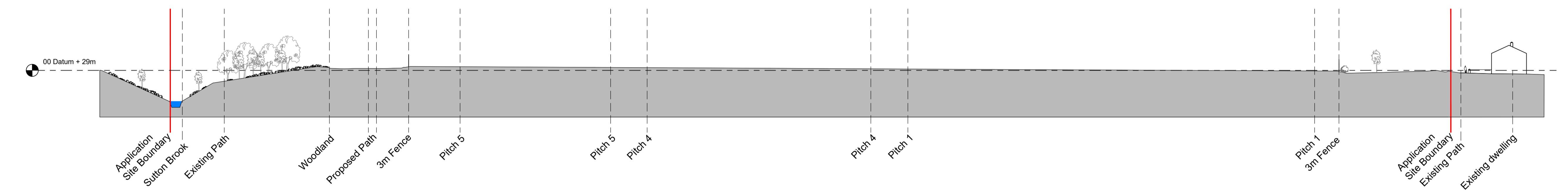

Proposed Section C-C - 1:500

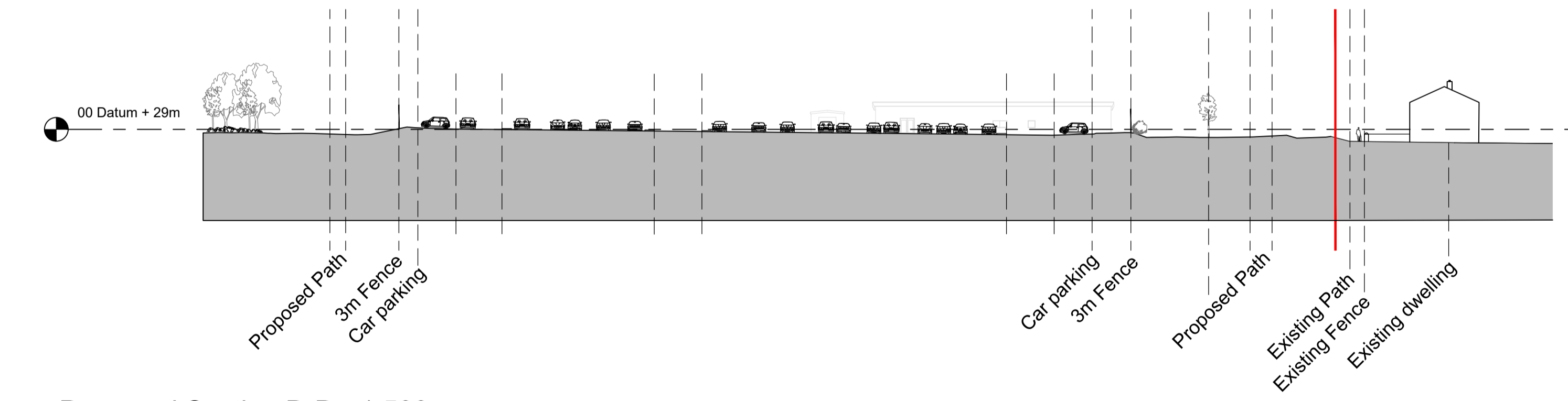

Proposed Section D-D - 1:500

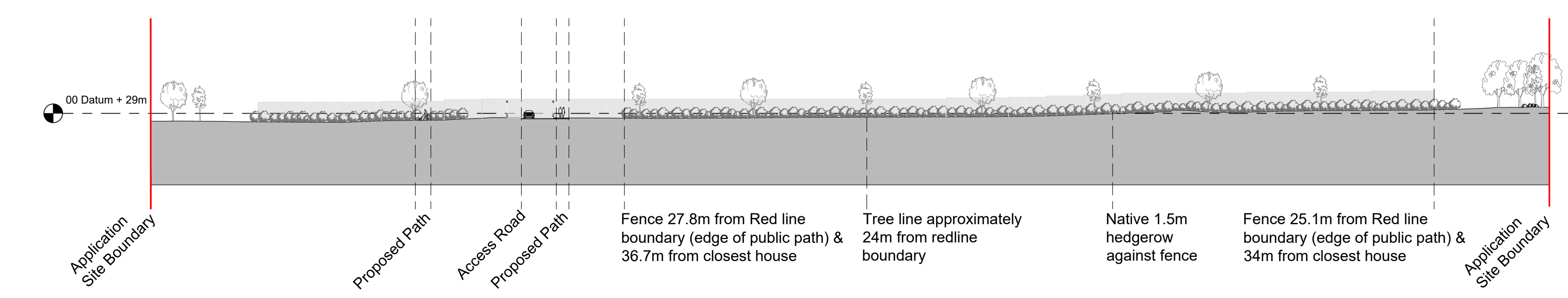

Proposed Section E-E - 1:500

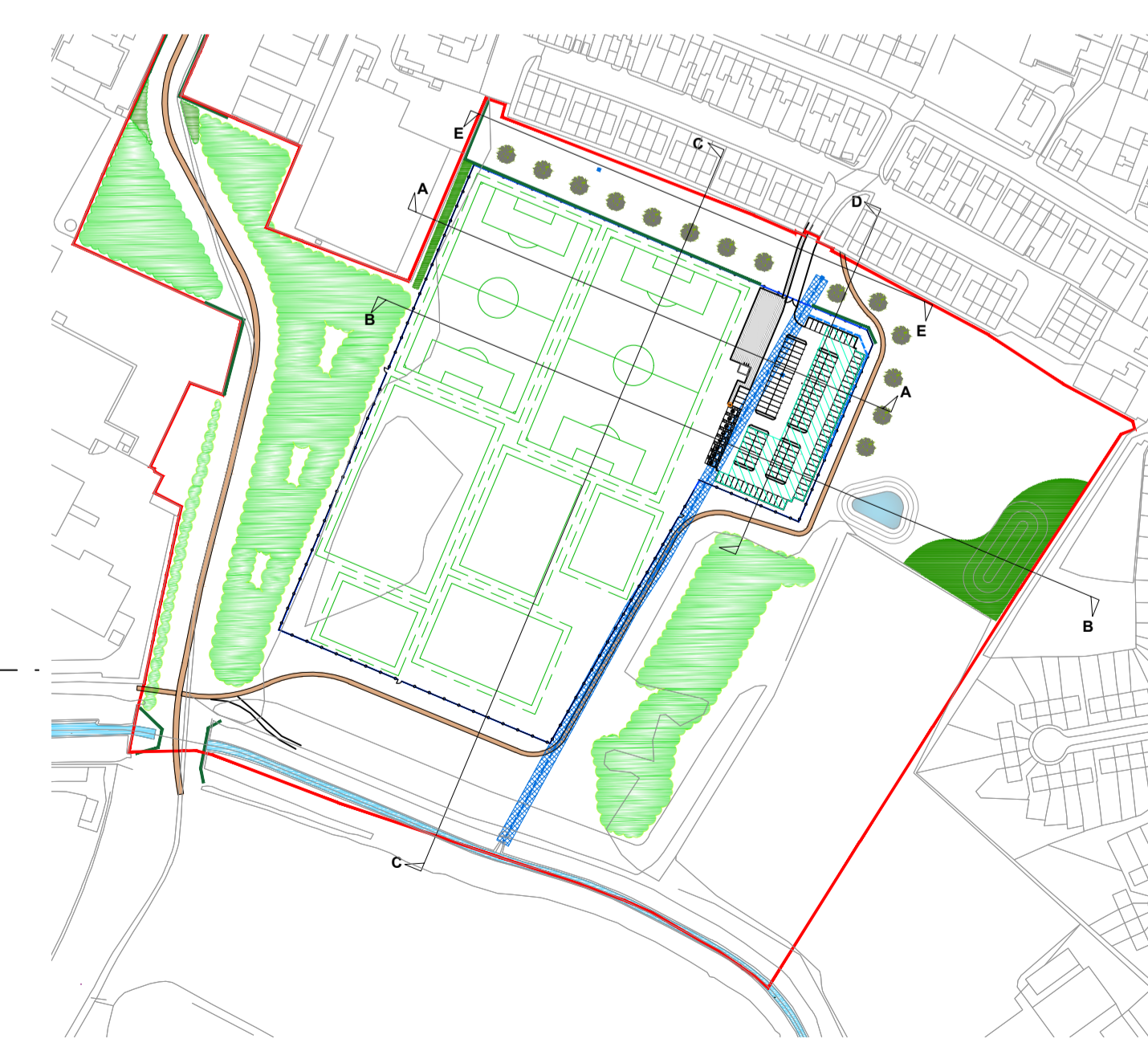

Key Plan - 1:2500

REV	Date	Drawn by	Checked by
P02	05/01/23	HN	AL
Section E-E added			
P01	04/01/23	HN	AL
Initial Issue			
drawing stage S2			
client			
Harworth Group			
project			
Moss Nook, St. Helens Phase 2			
drawing title			
Proposed Site Sections			
date	03/01/23	drawn	HN
scale@A1	1:500	checked	AL